







# SUPERSILO BIOMASS SOLUTIONS

Supersilo is one of the leading European companies manufacturing textile silos for biomass, agriculture and industry in general.

Direct contact with our customers makes us aware of their needs and helps us to develop innovative new products.

Supersilo boasts an international network of distribution and sales by a specialised technical team who will respond to your inquiries as quick as possible.

Do not hesitate to contact us to receive help and advice about our products.

# SILOS FULL OF ADVANTAGES

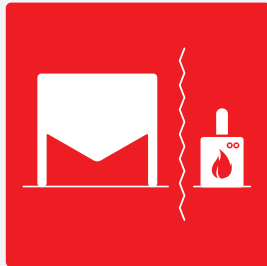

Possible to install at a considerable distance from the boiler

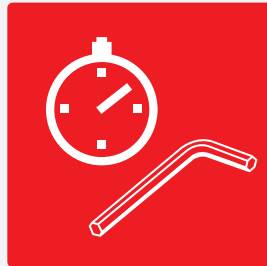

Simple and quick assemble



No special works are required



Does not stain



Does not generate dust



Capacity can be seen at a glance

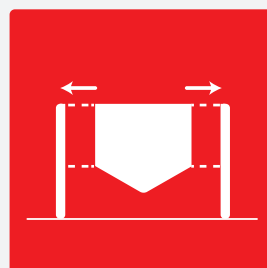

Collapsible



Portable



Wide range of sizes and capacities

## CERTIFICATES:



CE



FOOD SAFE



U.V. RAY



ANTISTATIC



DUST PERMEABILITY



RESISTANT



## THE MOST ROBUST SILO ON THE MARKET

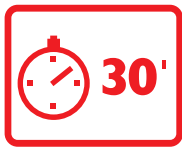

Assembly time:  
30 minutes

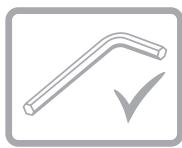

Only an allen key is  
needed

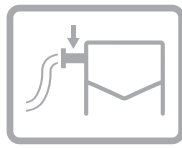

Filling pipe  
included



- Galvanized steel structure.
- Impact protection mat for pellets built in.

Article	Length (cm)	Width (cm)	Height (cm)	Volume (m³)	Tonnage (t)
SP120G	120	120	200-250	1,3-1,8	0,9-1,2
SP120X150G	150	120	200-250	1,7-2,2	1,1-1,4
SP120X170G	170	120	200-250	1,9-2,6	1,2-1,7
SP150G	150	150	200-250	2,1-2,8	1,3-1,9
SP150X170G	170	150	200-250	2,4-3,3	1,5-2,1
SP150X 200G	200	150	200-250	2,8-3,9	1,8-2,6
SP170G	170	170	200-250	2,8-3,8	1,8-2,5
SP170X200G	200	170	200-250	3,3-4,5	2,1-2,9
SP170X220G	220	170	200-250	3,6-4,9	2,3-3,2
SP200G	200	200	200-250	3,8-5,2	2,4-3,4
SP200X220G	220	200	200-250	4,3-5,9	2,8-3,8
SP200X250G	250	200	200-250	4,8-6,7	3,1-4,3
SP250G	250	250	200-250	6,1-8,5	4,0-5,5
SP250X220G	250	220	200-250	5,3-7,4	3,5-4,8
SP250X300G	300	250	200-250	7,2-10,1	4,6-6,5
SP300G	300	300	200-250	8,0-11,7	5,2-7,6

Article	Length (cm)	Width (cm)	Height (cm)	Volume (m³)	Tonnage (t)
SP120P	120	120	180-230	1,1-1,6	0,7-1,0
SP120X150P	150	120	180-230	1,4-1,9	0,9-1,2
SP120X170P	170	120	180-230	1,6-2,3	1,0-1,5
SP150P	150	150	180-230	1,8-2,5	1,1-1,7
SP150X170P	170	150	180-230	2,0-2,9	1,3-1,9
SP150X 200P	200	150	180-230	2,4-3,5	1,5-2,3
SP170P	170	170	180-230	2,4-3,4	1,5-2,2
SP170X200P	200	170	180-230	2,8-4,0	1,8-2,6
SP170X220P	220	170	180-230	3,0-4,3	1,9-2,8
SP200P	200	200	180-230	3,2-4,6	2,1-3,1
SP200X220P	220	200	180-230	3,5-5,1	2,3-3,3
SP200X250P	250	200	180-230	4,0-5,9	2,6-3,8
SP250P	250	250	180-230	5,1-7,5	3,3-4,8
SP250X220P	250	220	180-230	4,4-6,5	2,9-4,2
SP250X300P	300	250	180-230	5,9-8,8	3,8-5,7
SP300P	300	300	180-230	6,4-10,1	4,2-6,6

Note: The measurement unit may vary in terms of the pellet density and the filling method; and also depending on which extraction system is used.



## EVEN MORE ECOLOGIC



Assembly time:  
60 minutes

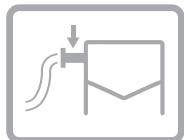

Filling pipe  
included



Natural and  
organic wood



- Wood structure with galvanized joints.
- Impact protection mat for pellets built in.

Article	Length (cm)	Width (cm)	Height (cm)	Volume (m <sup>3</sup> )	Tonnage (t)
ECO120P	120	120	180-230	1,1-1,6	0,7-1,0
ECO120x150P	150	120	180-230	1,4-1,9	0,9-1,2
ECO150P	150	150	180-230	1,8-2,5	1,1-1,7
ECO150x170P	170	150	180-230	2,0-2,9	1,3-1,9
ECO170P	170	170	180-230	2,4-3,4	1,5-2,2
ECO170x200P	200	170	180-230	2,8-4,0	1,8-2,6
ECO200P	200	200	180-230	3,2-4,6	2,1-3,1

Article	Length (cm)	Width (cm)	Height (cm)	Volume (m <sup>3</sup> )	Tonnage (t)
ECO120G	120	120	200-250	1,3-1,8	0,9-1,2
ECO120x150G	150	120	200-250	1,7-2,2	1,1-1,4
ECO150G	150	150	200-250	2,1-2,8	1,3-1,9
ECO150x170G	170	150	200-250	2,4-3,3	1,5-2,1
ECO170G	170	170	200-250	2,8-3,8	1,8-2,5
ECO170x200G	200	170	200-250	3,3-4,5	2,1-2,9
ECO200G	200	200	200-250	3,8-5,2	2,4-3,4

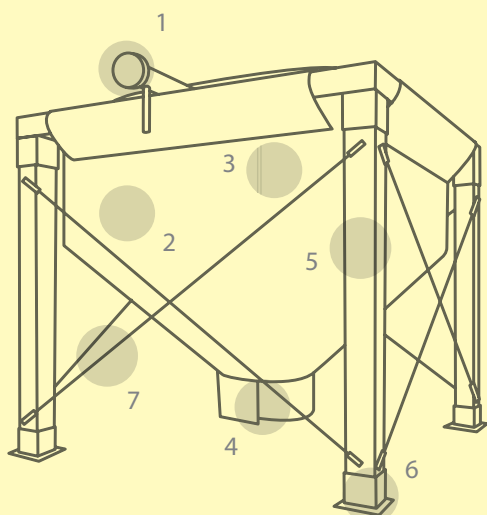

1. Filling pipe for the delivery truck.
2. Made from anti-static polyester fabric that allows the material to aerate but without expelling dust.
3. Pellet impact protection mat.
4. Extraction point. Different variations available.
5. Special plywood structure. Completely natural and organic.
6. Galvanized joints.
7. Steel cross-braces to increase stability.

Note: The measurement unit may vary in terms of the pellet density and the filling method; and also depending on which extraction system is used.

## IDEAL FOR NARROW PLACES

NEW



Assembly time:  
90 minutes



Vacuum extraction  
point

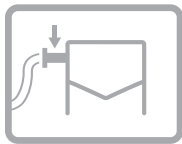

Filling pipe  
included

- Galvanized steel structure.
- Impact protection mat for pellets built in.
- Auger extraction system included.



Article	Length (cm)	Width (cm)	Height (cm)	Volume (m <sup>3</sup> )	Tonnage (t)
REC200X100P	200	100	180-230	2,2-3,0	1,4-1,9
REC250X100P	250	100	180-230	2,8-3,8	1,8-2,5
REC250X150P	250	150	180-230	3,9-5,4	2,5-3,5
REC300X100P	300	100	180-230	3,5-4,6	2,2-3,0
REC300X150P	300	150	180-230	4,7-6,5	3,0-4,2
REC300X200P	300	200	180-230	5,8-8,3	3,8-5,4

Article	Length (cm)	Width (cm)	Height (cm)	Volume (m <sup>3</sup> )	Tonnage (t)
REC200X100G	200	100	200-250	2,5-3,3	1,7-2,2
REC250X100G	250	100	200-250	3,3-4,3	2,1-2,8
REC250X150G	250	150	200-250	4,5-6,0	3,0-4,0
REC300X100G	300	100	200-250	4,0-5,1	2,6-3,4
REC300X150G	300	150	200-250	5,5-7,3	3,5-4,7
REC300X200G	300	200	200-250	6,9-9,4	4,5-6,1

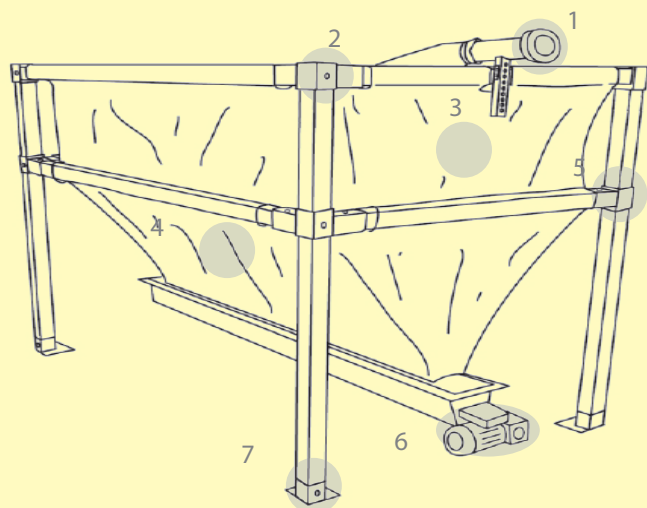

1. Filling pipe for the delivery truck.
2. Galvanized joints.
3. Pellet impact protection mat.
4. Intermediate galvanised bars for additional strength.
5. Made from anti-static polyester fabric that allows the material to aerate but without expelling dust.
6. Extraction point for auger.
7. Galvanized steel bars.

Note: The measurement unit may vary in terms of the pellet density and the filling method; and also depending on which extraction system is used.



# MEGASILO

## 20% MORE CAPACITY\*



Flat bottom:  
+20% capacity

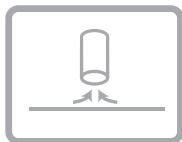

Extraction point

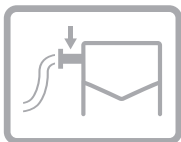

Filling pipe  
included

- Galvanized steel structure.
- Includes a vibration unit and vacuum extraction system.
- Not suitable for auger extraction.
- Impact protection mat for pellets built in.



Article	Length (cm)	Width (cm)	Height (cm)	Volume (m <sup>3</sup> )	Tonnage (t)
MEGASILO 160P	160	160	180-230	2,5-3,3	1,6-2,2
MEGASILO 180P	180	180	180-230	3,3-4,4	2,1-2,9
MEGASILO 200P	200	200	180-230	4,1-5,6	2,6-3,6
MEGASILO 220P	220	220	180-230	5,1-6,9	3,3-4,5

Article	Length (cm)	Width (cm)	Height (cm)	Volume (m <sup>3</sup> )	Tonnage (t)
MEGASILO 160G	160	160	200-250	2,9-3,7	1,8-2,4
MEGASILO 180G	180	180	200-250	3,8-4,9	2,4-3,2
MEGASILO 200G	200	200	200-250	4,8-6,3	3,0-4,0
MEGASILO 220G	220	220	200-250	5,9-7,7	3,8-5,0

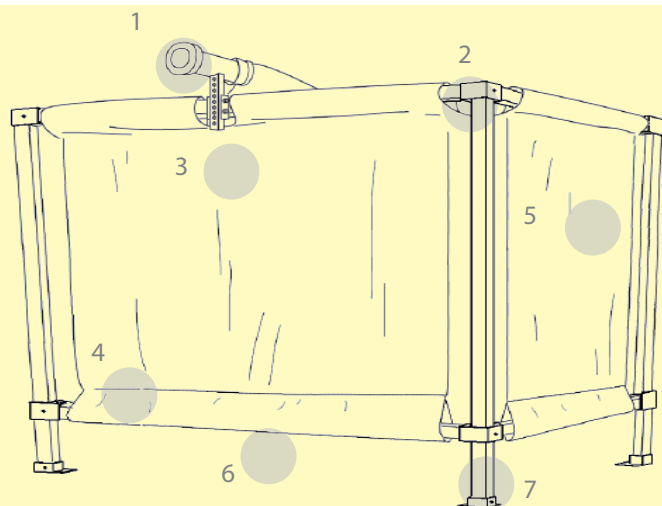

1. Filling pipe for the delivery truck.
2. Galvanized joints.
3. Pellet impact protection mat.
4. Intermediate galvanized bars for additional strength.
5. Made from anti-static polyester fabric that allows the material to aerate but without expelling dust.
6. Extraction point with vibrator included.
7. Galvanized steel bars.

Note: Volume and capacity of the unit may vary depending on the pellet density and the filling method and also which extraction system is used.  
\*In comparison to other Supersilo-models the percentage may vary depending on the height of the silo.

# MINISILO AND KIT MINISILO

## PERFECT FOR YOUR BOILER OR HEATER



No top cover



Lowest cost option



Natural and organic wood

- Ideal for small locations.
- Manual filling.



Article	Length (cm)	Width (cm)	Height (cm)	Volume (m <sup>3</sup> )	Tonnage (t)
MINISILO 100	100	100	130	0,53	0,35
MINISILO 130	130	130	130	0,95	0,62

## KIT MINISILO : THE COMPLETE SOLUTION FOR AN AUTOMATIC SUPPLY MINISILO + AUGER EXTRACTION SYSTEM + KIT AUTO



No top cover

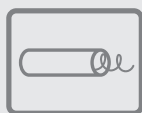

Auger extraction



Electric motor included



Level sensor

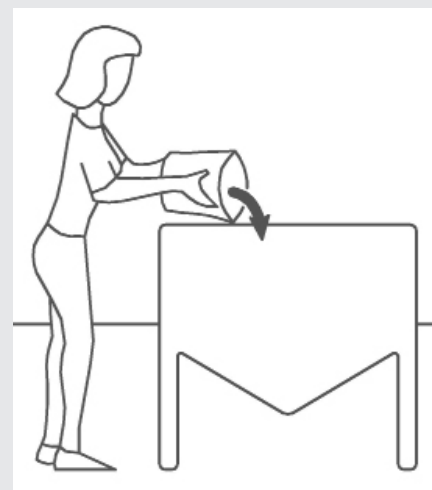
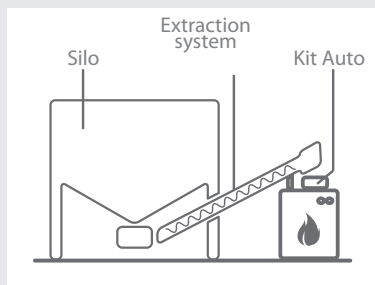

Article	Length (cm)	Width (cm)	Height (cm)	Volume (m <sup>3</sup> )	Tonnage (t)
KIT MINISILO 100	100	100	130	0,53	0,35
KIT MINISILO 130	130	130	130	0,95	0,62

Note: The measurement unit may vary in terms of the pellet density and the filling method; and also depending on which extraction system is used.



# MADE-TO-MEASURE SILOS

## THE PERSONALIZED SOLUTION

Complete  
customisation to the  
needs of your project.  
For each installation we  
can provide a solution.

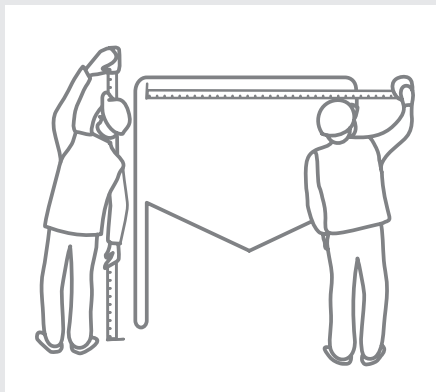

## OUTDOOR ACCESSORY

### OUTDOOR SILO COVER



Choice of colour



Silo not included

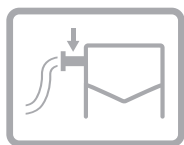

Filling pipe  
included

- Only available for steel structures.
- Extraction by vacuum.
- Extraction by auger.
- Special filling pipe to allow easy filling.



Flexible PVC protection against  
rain and other meteorological  
disturbances.

Avoids condensation caused by  
humidity.

# EXTRACTION SYSTEMS

WE HAVE SYSTEMS THAT ADAPT TO ALL THE BOILERS ON THE MARKET

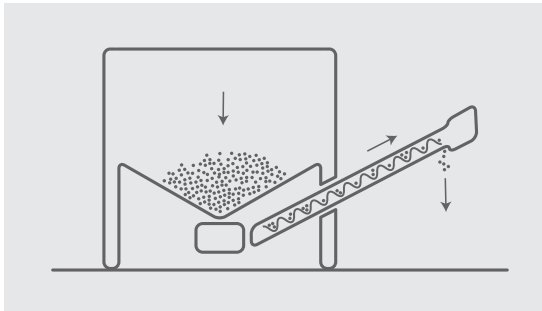

## RIGID AUGER

Silos can be adapted to many types of extraction systems and for rigid and flexible augers.

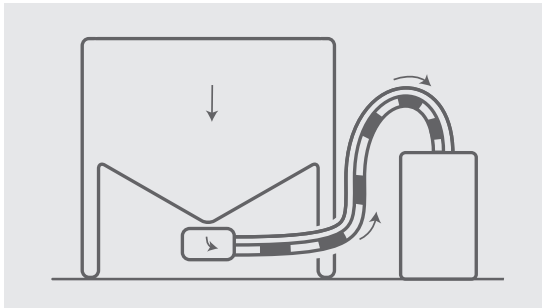

## PNEUMATIC SUCTION

Silos with an extraction system by vacuum need an extraction hose for the pellet delivery and another and for the return air.

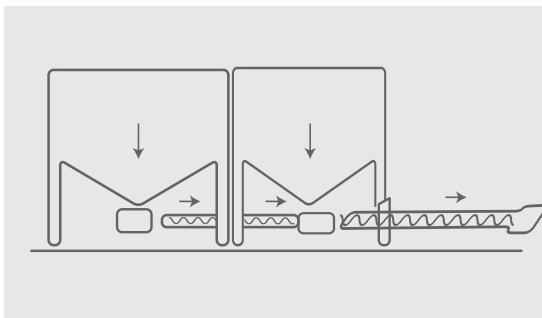

## MULTIPLE SILOS

It is also possible to connect several silos using an auger system. The filling of the boiler can be by vacuum or auger system.

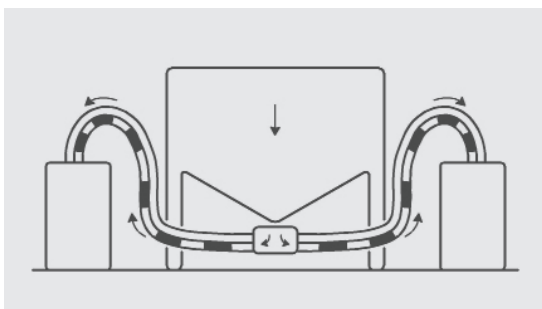

## TWO BOILERS

It is possible to fill two boilers from one common silo. Either vacuum or an auger can be used.



# AUTOMATION SYSTEM FOR BOILERS WITH MANUAL FILLING

## AUTOMATIC TRANSPORT SYSTEM WITH AUGER + KIT AUTO

The ideal solution for short distances. Traditional mechanical system to fill a boiler or auxiliary hopper.

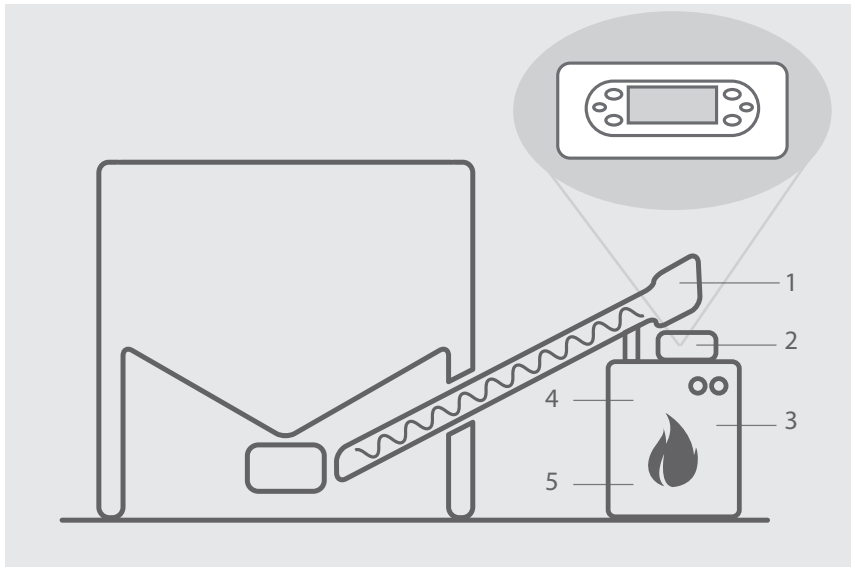

1. The auger motor is available in different power and fill rates options according to the needs of the client and the power of the boiler or heater.
2. Kit Auto manages the starting and stopping of the auger motor. In operation, the auger spins and transports the pellets. The menu screen of this item can be set to different languages and allows scheduled programming.
3. Boiler, heater or auxiliary hopper.
4. Minimum level sensor.
5. Maximum level sensor.

## AUTOMATIC TRANSPORT SYSTEM WITH VACUUM

Long distances: up to 20 metres. Adaptable to each boiler and completely programmable. For wood pellets and olive stones.

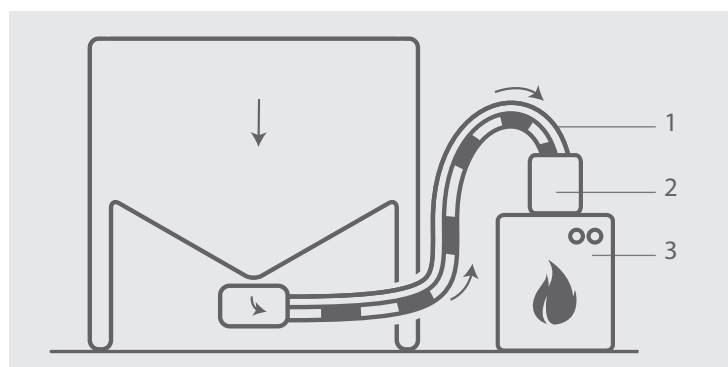

1. Vacuum hose with a diameter of 50mm for the flow and return.
2. Vacuum system for feeding (Vacupellet item).
3. Biomass boiler hopper.

# BIOMASS PNEUMATIC TRANSPORTER

## VACUPELLET



Vacuum extraction

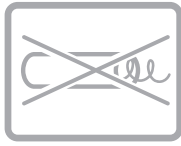

Not suitable for  
auger extraction



Level sensor

- Maximum suction distance 20 metres horizontal and 6 metres vertical.
- Automatic transport of pellet and bones.
- Store capacity: 13l (8kg).
- Scheduled programming or non-stop working.
- Allows management of a vibration unit or of an auger.
- Includes a capacity sensor.
- Power 1600 W.



## MINIVACUPELLET



Vacuum extraction



Not suitable for  
auger extraction



Level sensor

- Maximum suction distance 20 metres horizontal and 6 metres vertical.
- Automatic transport of pellet and bones.
- Store capacity: 3l (2kg).
- Scheduled programming or non-stop working.
- Allows management of a vibration unit or of an auger.
- Includes a capacity sensor.
- Power 1600 W.
- Suitable for boiler and heater.
- Complete integration in the boiler.

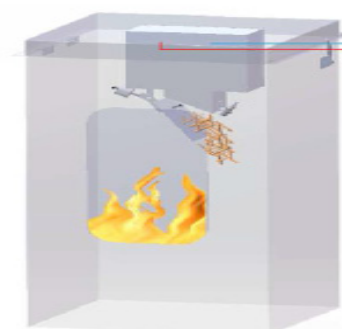
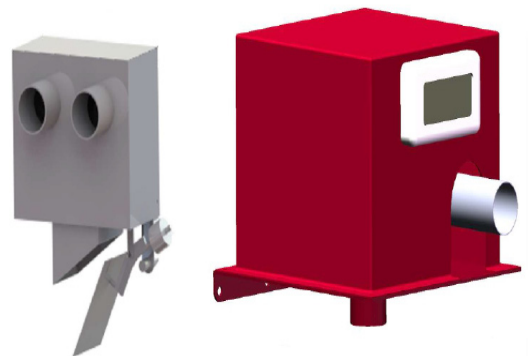

# DIFFERENT EXTRACTION SYSTEMS

## PNEUMATIC FILLING

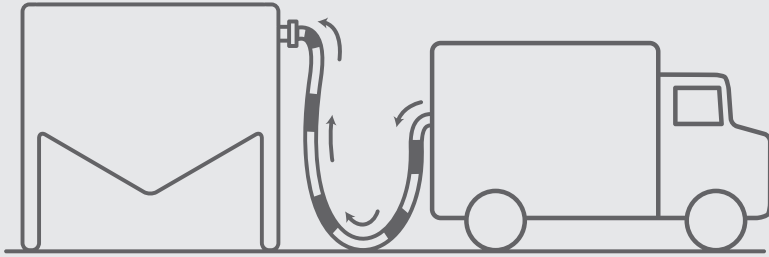

Filling the silo by a pneumatic system. With our silos it is only necessary to connect one hose from the truck and to be aware of the maximum filling pressure of 0,8 bar.

Our silos can be filled from a pneumatic truck that blows pellet through a hose into the silo. All our silos include a coupling to connect the hose to the truck. Thanks to the design of the fabric it is only necessary to have one filling connection which allows the air to filter out, but prevents any dust from escaping.

## MANUEL FILLING BY SACKS OR BIG BAGS

It is possible to fill the silo by manually filling from sacks or big bags, thanks to a filling sleeve that is sewed either on the cover or on the side. We can also position a zipper on the top cover to allow the silo to be filled from above.

This incorporates a security closure to avoid pellets or dust escaping.

Manual filling is especially useful for users who cannot fill the silo from a bulk delivery truck or may experience problems with pellet truck deliveries. It is also very useful for commissioning the boiler.

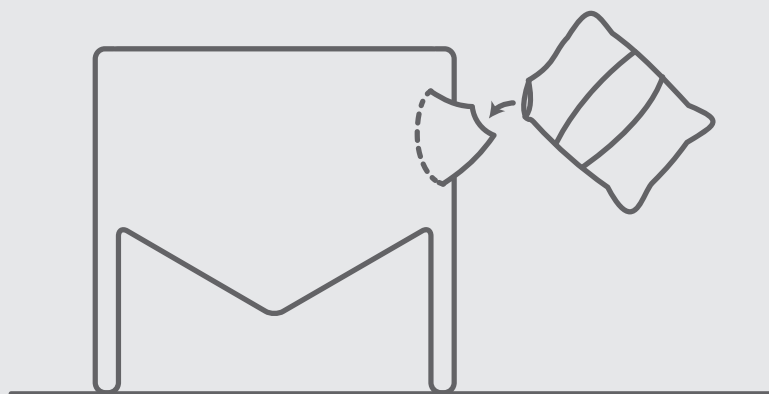

### SIDE FILLING:

Side filling of the silo by sacks or small bags trough a sleeve, suitable for pellets, olive bones and granual material.

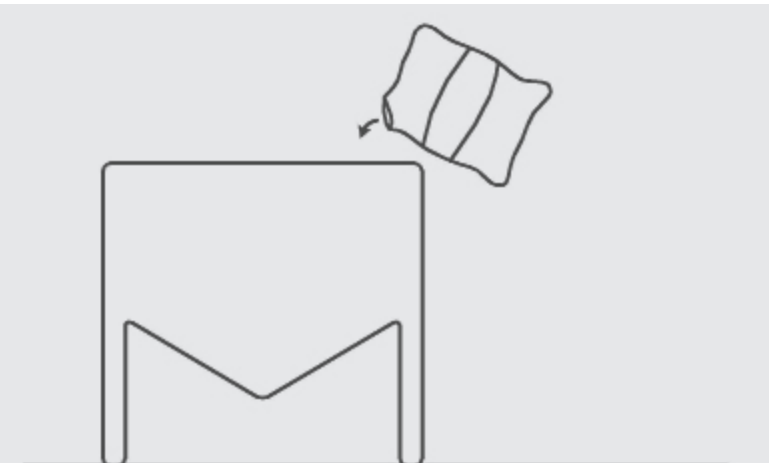

### UPPER FILLING:

Top filling the silo by big bags via a zipper on the top, suitable for pellets, olive bones and granual material.

# BUNKER SILOS ACCESSORIES

## 1 - PELLET IMPACT PROTECTION MAT

SBR Rubber protection mat to cut down on the pellet damage during filling.

Situation: Placed opposite of the filling pipes.

## 2 - STORZ/GUILLEMIN COUPLING

Filling pipe with a connector for pneumatic trucks.

Two filling pipes are recommended for bunker silos.

Extension and piece of transition are also available for your couplings.

## 3 - Z-PROFILE DOOR

Galvanized rails to support the wood boards that protect the access door to the silo to enable maintenance.

## 4 - U-TROUGH AUGER

Screw thread in sections with axis and bearing.

Motor included.

Fuel extraction to a vacuum connection.

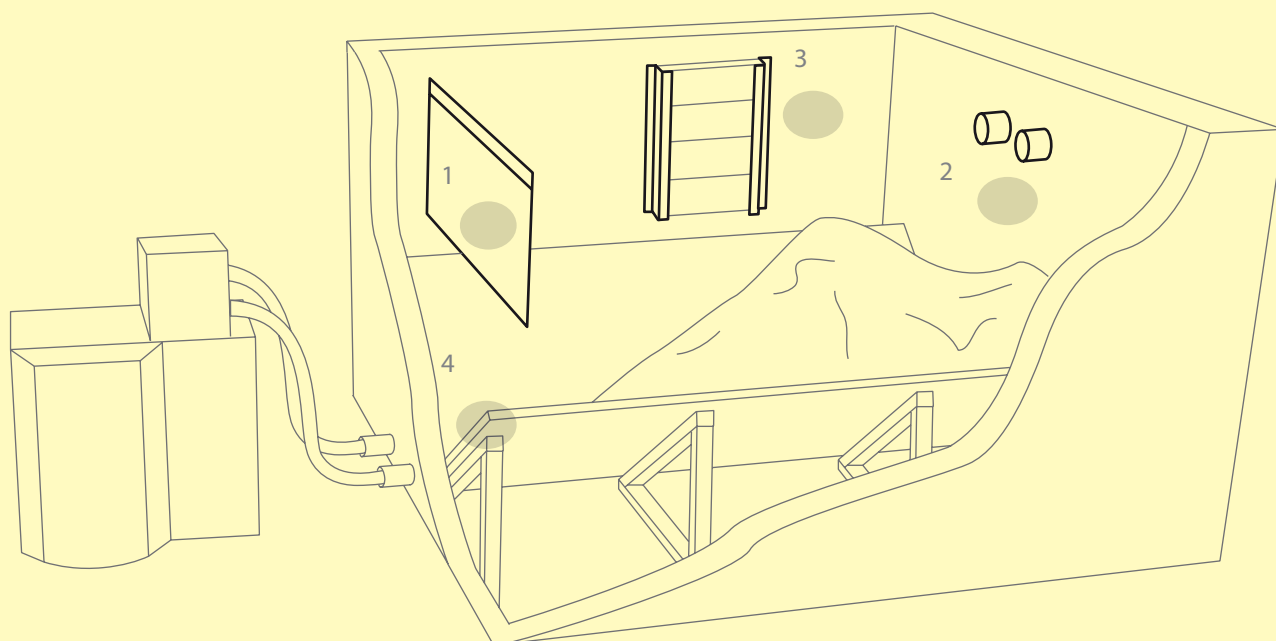





**BIOMASS**  
SOLUTIONS

Supersilo Spain  
P. Asipo Calle A Parcela 3A Nave 7  
33428 Llanera  
Asturias - Spain  
Tel.: +34 985 673 790  
E-Mail: [info@supersilo.es](mailto:info@supersilo.es)  
[www.supersilo.es](http://www.supersilo.es)

The company reserves the right to change its products or specifications at any time without notice.  
The images and descriptions in this catalogue may not be an exact representation of the final product.  
© Copyright 2015.

